

| REVISION HISTORY | | | |
|------------------|-----------------------------|---------|----------|
| REV | DESCRIPTION | DATE | APPROVED |
| 1 | UPDATED TO SHOW MORE DETAIL | 11/7/22 | 11/7/22 |

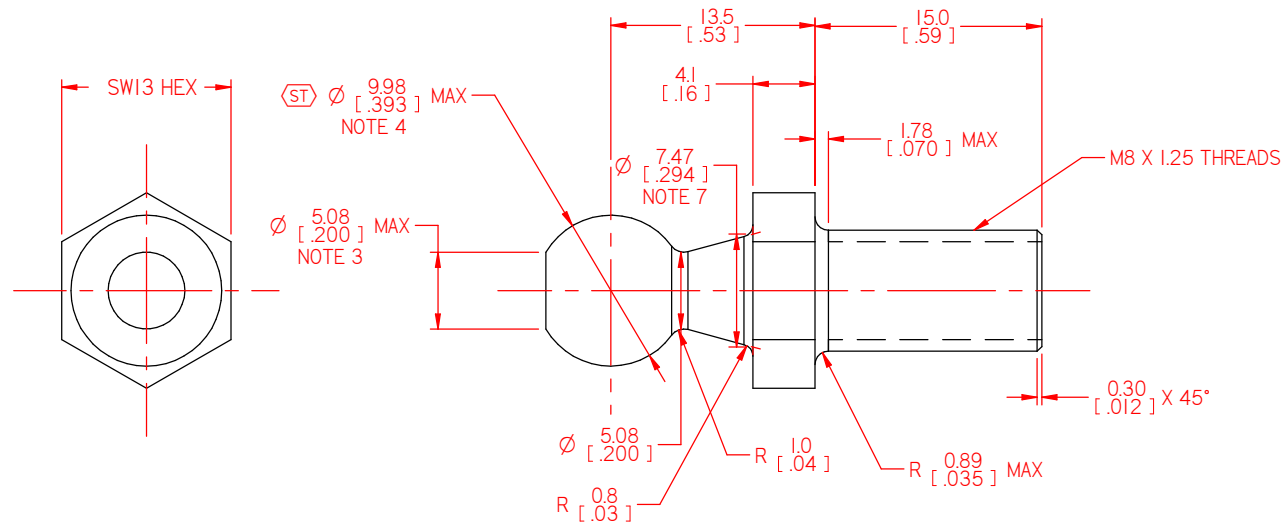

- NOTES:
- 1) MATERIAL: Q215 STEEL.
 - 2) FINISH: ZINC PLATE 0.0038 [00015] THICK MINIMUM.
 - 3) DIAMETER FLAT IS PERMISSIBLE.
 - 4) SPHERICAL DIAMETER TO BE 9.88 [389] MINIMUM BEFORE FINISH.
 - 5) DIMENSIONAL LIMITS APPLY AFTER FINISH.
 - 6) FEATURES IDENTIFIED AS STATISTICALLY TOLERANCED (ST) SHALL BE PRODUCED WITH STATISTICAL PROCESS CONTROLS.
 - 7) THEORETICAL SHARP CORNERS.

| | | | |
|--|--|------------------------|---------|
| NORMONT | | NAME | DATE |
| | | DRAWN K. GERALD | 11/7/22 |
| CHECKED | | | |
| DWG NO | | NBS01-04 | REV 1 |
| TITLE | | Ball Stud | |
| TOLERANCES | | THIRD ANGLE PROJECTION | SCALE |
| X.X | ±0.25 | | 4:1 |
| X.XX | ±0.13 | | SIZE |
| X.XXX | ± | | C |
| ANGLES | ±3.0° | SHEET 1 OF 1 | |
| HOLES | ±0.005 | | |
| REMOVE ALL BURRS & BREAK ALL SHARP EDGES | ALL DIMENSIONS ARE DUAL UNLESS OTHERWISE SPECIFIED | | |